

// Tube Cutter, Flaring & Swaging Tool Set



- 45° Flares and swages soft steel tubing such as soft copper, Aluminum and brass tubing
- Swages in close quarters where punch style cannot be used
- Flaring bar with size capacity: 1/8", 3/16", 1/4", 5/16", 3/8", 7/16", 1/2", 5/8", 3/4" O.D. tubing
- Tube cutter capacity: 1/8" to 1-1/8"
- Swage adapters: 3/16", 1/4", 5/16", 3/8", 1/2", 5/8", 3/4"

ITEM NO. **CONTENTS** 10 (SET)

- JGAI1001**
- 1 Flaring Bar (Small Size)**
1/8", 3/16", 1/4", 5/16", 3/8", 7/16" O.D. Tubing
 - 1 Flaring Bar (Large Size)**
1/2", 5/8", 3/4" O.D. Tubing
 - 1 Tube Cutter W/Retractable Reamer**
Cutting capacity: 1/8" to 1-1/8"
 - 1 Steel Yoke**
 - 5 Swaging Adapter**
3 in 1 (3/16", 1/4", 3/8"), 5/16", 1/2", 5/8", 3/4"
 - 1 45° Flaring Adapter**

BLOW CASE: W265 x D215 x H62 (mm)

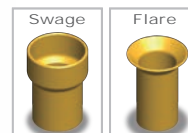

// Tube Cutter & Double Flaring Tool Set



- Specially designed tool kit to double flare tubing for high pressure application in automotive, air conditioning and etc.
- Accurately single or double flares soft steel tubing such as cooper, Aluminum and brass tubing for leak free connections
- Screw-type 45° flaring press
- Tube cutter capacity: 1/8" to 1-1/8"
- Flaring bar & adapter sizes: 3/16", 1/4", 5/16", 3/8", 7/16", 1/2" & 5/8"

ITEM NO. **CONTENTS** 10 (SET)

- JGAI1002**
- 1 Flaring Bar**
3/16", 1/4", 5/16", 3/8", 7/16", 1/2", 5/8" O.D. Tubing
 - 1 Tube Cutter W/Retractable Reamer**
Cutting capacity: 1/8" to 1-1/8"
 - 1 Steel Yoke W/45° Flaring Cone**
 - 7 Flaring Adapter**
3/16", 1/4", 5/16", 3/8", 7/16", 1/2", 5/8" O.D. Tubing

BLOW CASE: W265 x D215 x H62 (mm)

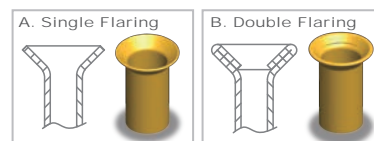

// 7PCS

Air Blow and Suction Gun

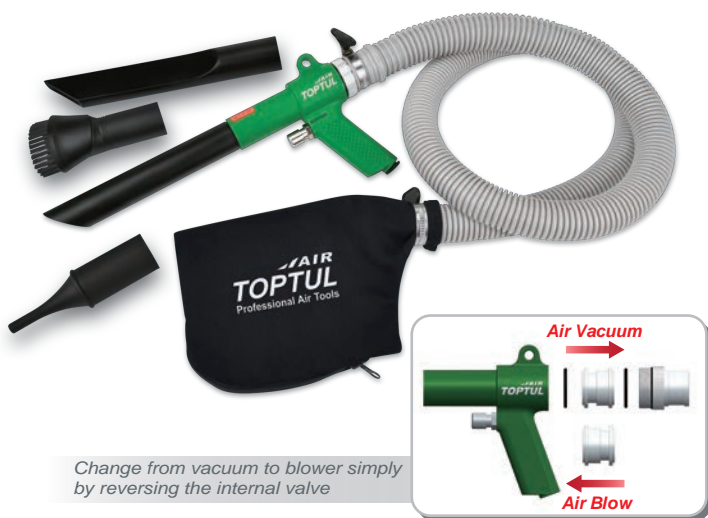

Change from vacuum to blower simply by reversing the internal valve

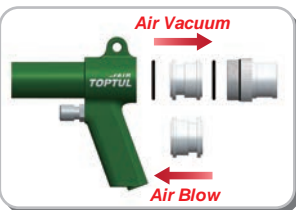

ITEM NO. **GDAE0702** 10 (SET)

- Air Inlet: 1/4" PT
- Working Pressure: 90 PSI
- Simply change the installation direction of the inner valve to convert between air blower to vacuum
- Ideal cleaning accessory for garages and workshops
- Suitable for cleaning car seat, engine room, cabinet, wood chips, metal shavings, powders and etc.
- Contents: Aluminum gun, flexible hose, dust bag, extension tube, small tube, flat tube and brush

// 8PCS

Air Blow and Suction Gun (One-Hand Switchable Type)



One-hand reversing vacuum / blower switch



ITEM NO. **GDAE0801** 10 (SET)

- Air Inlet: 1/4" PT
- Working Pressure: 90 PSI
- One-touch regulator knob quickly converts between air blower to vacuum
- Ideal cleaning accessory for garages and workshops
- Suitable for cleaning car seat, engine room, cabinet, wood chips, metal shavings, powders and etc.
- Content: Aluminum gun, flexible tube, dust bag, extension tube, small tube, flat tube, flexible hose and brush