

3/8" DR. Oxygen Sensor Socket (Low Profile Offset)

CR-MO



- Made of Chrome Molybdenum Steel, heat treated, black oxide finish
- Remove & install sensors on computerized engine control vehicles
- 3/8" DR. 7/8" (22mm) 6PT socket with cutaway length 30mm portion for wire clearance
- Offset design for confined areas

ITEM NO.	SIZE (mm)	L (mm)		
JDAR1222	22	30	25	100

1/2" DR. Oxygen Sensor Socket

CR-V



- Made of Chrome Vanadium Steel, heat treated, black oxide finish
- Remove & install sensors on computerized engine control vehicles
- 1/2" DR. 1-1/16" (27mm) 12PT socket with cutaway portion for wire clearance

ITEM NO.	SIZE (mm)	L (mm)		
JDAQ1627	27	78	10	100

1/2" DR. Heated Oxygen Sensor Socket

CR-MO



- Made of heat treated, durable Chrome Molybdenum Alloy Steel
- Remove & install sensors on computerized engine control vehicles
- 7/8" (22mm) Hex, 1/2" Square Drive (double square for easy access)
- Socket with cutaway portion for wire clearance
- Offset design for confined areas
- Material: CR-MO
- Finish: Black oxide

ITEM NO.	SIZE (inch)	L (mm)		
JDAR0122	7/8	50	10	100

3/8" DR. Oxygen Sensor Vacuum Switch Socket

CR-V



- Made of heat treated Chrome Vanadium Steel
- Install and removes oxygen sensors and vacuum switches on computerized engine control vehicles
- 22mm (7/8") 6-point socket with cutaway slot provides extra clearance for sensor wires
- Use with 3/8" square drive tools or 1" end wrench on the external hex
- Black phosphate finish for added corrosion resistance

ITEM NO.	SIZE (mm)	L (mm)		
JDAQ0122	22	90	12	72

1/2" DR. Oxygen Sensor Socket

CR-MO



ITEM NO.	SIZE (mm)	L (mm)		
JDAQ1622	22	85	20	80

7PCS

Sensor & Sending Unit Socket Set

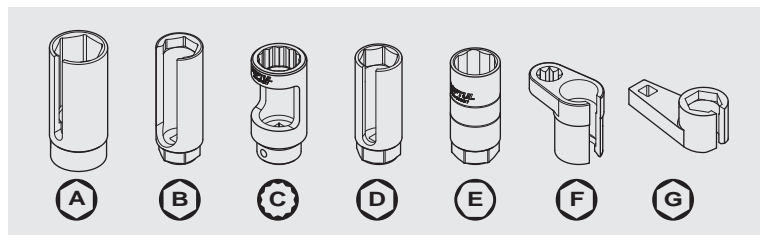

ITEM NO.	CONTENTS	DRIVE	SIZE (inch)	L (mm)		10 (SET)
JGAI0701	1 JDAS0129 A Oil Pressure Sending Unit Socket	1/2"	1-3/16 (29mm)	90		
	1 JDAQ0122 B Universal Vacuum PVS, TVS Valve and Oxygen Sensor Socket	3/8"	7/8	90		
1 JDAR0122	1 JDAQ1627 C GM Thermal Sensor Switch Socket	1/2"	1-1/16 (27mm)	78		
	1 JDAQ0222 D Oxygen Sensor Socket	3/8"	7/8	80		
1 JDAS0227	1 JDAR0122 E Oil Pressure Sending Unit Socket	3/8"	1 & 1-1/16	74		
	1 JDAR0122 F Heated Oxygen Sensor Socket	1/2"	7/8	50		
1 JDAQ0222	1 JDAR0122 G Low Profile Offset Oxygen Sensor Socket	3/8"	7/8	30		

- Set contains 7 assorted sockets for removal and installation of Oxygen Sensor, Oil Pressure Sending Units and Vacuum Switches
- Specially designed tools to use and work on a variety of vehicles
- Sockets are made of heat treated, durable Chrome Vanadium Alloy Steel (A-E) and Chrome Molybdenum Alloy Steel (F&G)

BLOW CASE: W232 x D203 x H54 (mm)