



TOPTUL
Hammers & Striking Tools

Engineers Hammer



ITEM NO.	HEAD WGT(g)	HEAD Sq.(mm)	L (mm)		
HAAA0330	300	23	300	6	48
HAAA0532	500	27	320	6	36
HAAA0835	800	33	350	6	24
HAAA1036	1000	36	360	4	16
HAAA1538	1500	42	380	4	12
HAAA2040	2000	47	400	4	12

Spare Handles ☆

- With wedge
- Hickory handle for engineer's hammer (HAAA series)



ITEM NO.	L(mm)	APPLY TO		
HLAB0130	300	HAAA0330 - 300g	10	40
HLAB0132	320	HAAA0532 - 500g	10	40
HLAB0135	350	HAAA0835 - 800g	10	40
HLAB0136	360	HAAA1036 - 1000g	5	20
HLAB0138	380	HAAA1538 - 1500g	5	20
HLAB0140	400	HAAA2040 - 2000g	5	20

Soft Face Hammer

- Comes with two interchangeable and replaceable soft faces hammer heads, PU (yellow) and Nylon (white) durable plastic material
- Genuine hickory wooden handle



ITEM NO.	HEAD Ø(mm)	L (mm)	PU/ Nylon Material	
HAAF3530	35	303	6	48

Spare Plastic Tip for Mallets

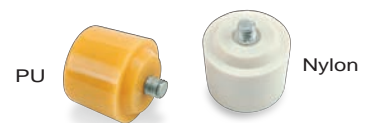

ITEM NO.	SIZE	MATERIAL		
HLAA3501	Ø35mm	PU	40	240
HLAA3502	Ø35mm	Nylon	40	240

Fiberglass Club Hammer

- Head Material: High grade medium carbon steel
- Head Finish: Black baked paint finish, striking face polished
- Fiberglass core provides strength and durability in the handle
- Anti-slip bi-component PP+TPR material soft grip handle
- Manufacturing according to DIN 6475



ITEM NO.	HEAD WGT(lb)	HEAD Sq.(mm)	L (mm)		
HABE2226	2.2	40	260	4	16

Fiberglass Engineers Hammer

- Head Material: High grade medium carbon steel
- Head Finish: Black baked paint finish, striking face polished
- Fiberglass core provides strength and durability in the handle
- Anti-slip bi-component PP+TPR material soft grip handle



ITEM NO.	HEAD WGT(g)	HEAD Sq.(mm)	L (mm)		
HABA0532	500	27	320	6	36